



Kifaru Marauder Handbook

Pack Anatomy 1-3
 Using the Dock & Lock 1-2
 Pack Interior 4
 Add a Chamber or PullOut 4
 Add a Radio Pouch 5
 Add a CargoChair 6
 Piggyback System 7-10
 Add a Combat GunBearer 11-14
 Waistbelt Removal back cover

ANATOMY - FRONT & INTERIOR

Pocket Options, Interior - takes any MOLLE compatible pocket, or any Kifaru pocket

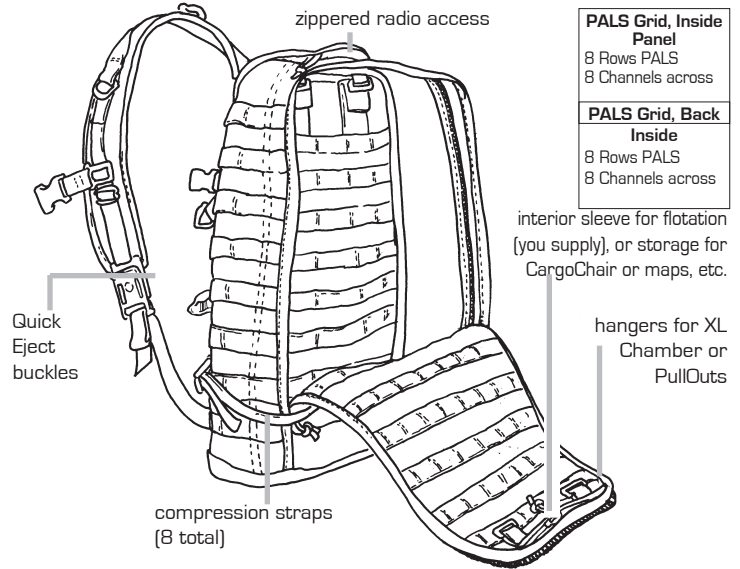

PACK PARTS

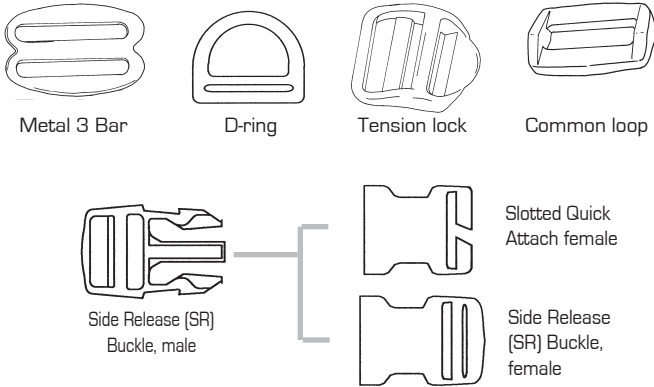

all information is copyright 2007, Kifaru International

KIFARU, INTL • 4894 Van Gordon St., Ste. #305, Wheat Ridge, CO 80033 • www.kifaru.net • 1-800-222-6139

USING THE DOCK & LOCK



The Dock & Lock lets you quickly attach & detach any Kifaru pocket that is equipped with the D&L System.

To Attach:

Slide the Slotted Quick Attach Female onto any span of PALS webbing.

KIFARU POCKET PLACEMENT OPTIONS

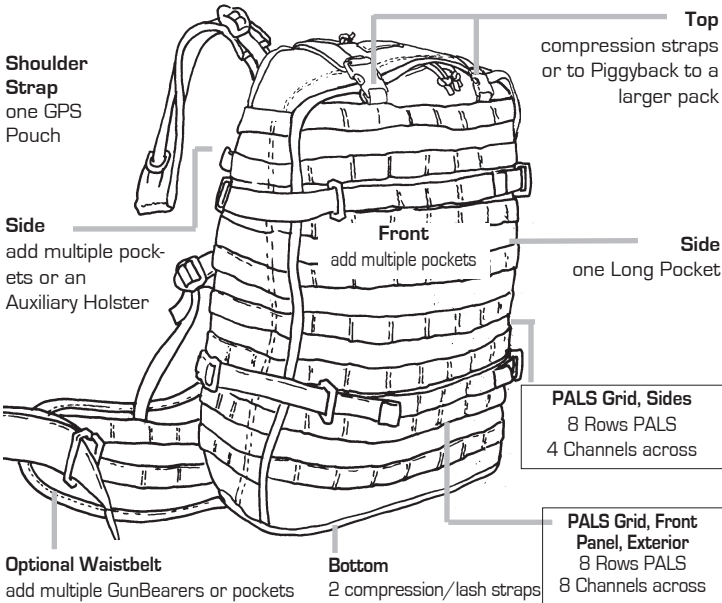

ANATOMY OF THE BACK

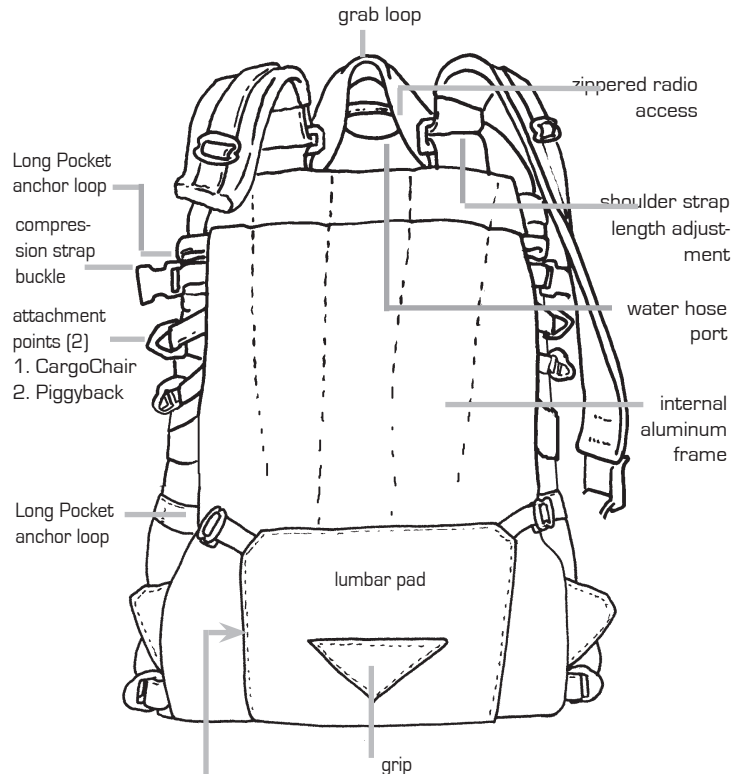

Optional waistbelts attach here and are removable.

USING THE DOCK & LOCK

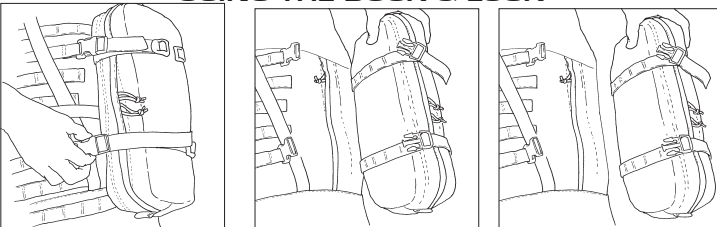

To Detach: Squeeze the Side Release buckle

pull pocket back

or release all 4 points, remove completely **2.**

3.

THE INTERIOR

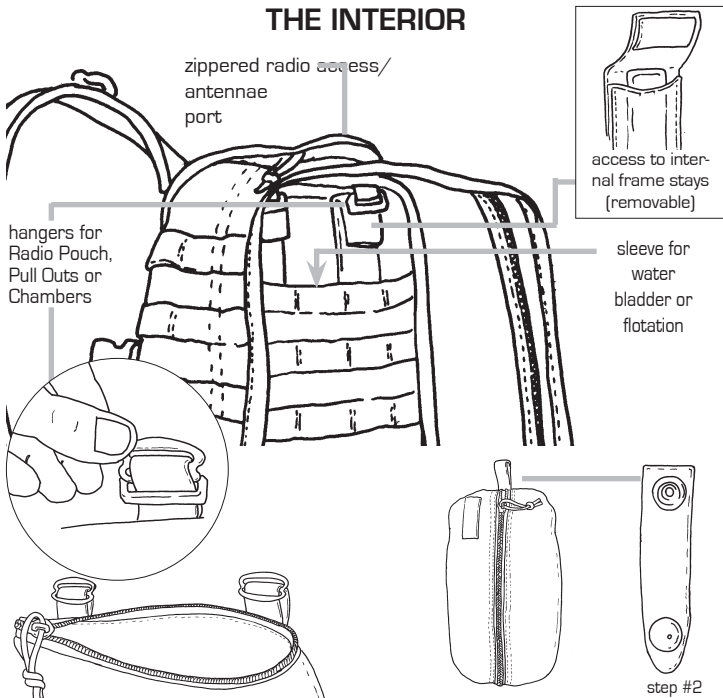

ADDING A PULLOUT

- In conjunction with a Chamber:** thread the metal 3 bar on the Chamber through the top loop.
- Without a Chamber:** thread the PullOut top loop through the common loop. Run a Snap Clip through the end of the PullOut loop and secure. You can also attach anywhere there is PALS webbing.

ADDING A CHAMBER

Your pack will come with a removable, standard Chamber. Add a Padded or XL Chamber by threading the 3-bars through the common loop hangers.

INTERIOR - ADDING A RADIO POUCH

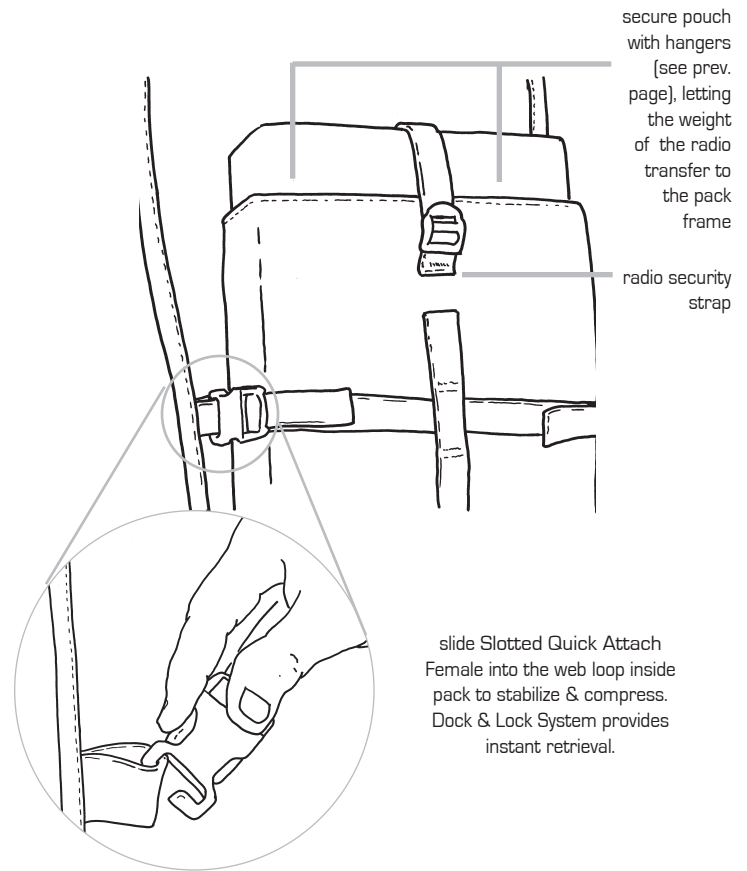

5.

ADDING A CARGOCHAIR™ pat. pend

1. UPPER ATTACHMENTS

Each side of your pack has a pair of triangle loops. Thread the 3-bar through the ONE that is rearmost (the other triangle is for Piggyback attachments).

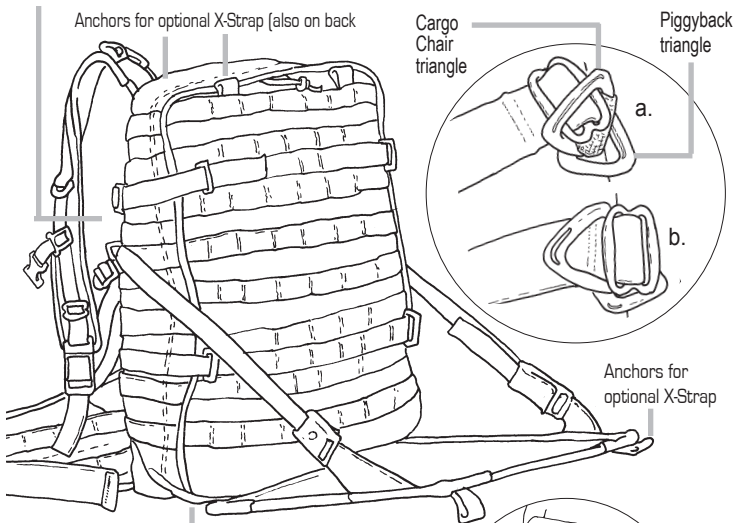

2. LOWER ATTACHMENT

Your pack bottom has two common loop attachments. Thread the 3-bar through each.

CargoChair™ as a Chair

Simply lengthen the straps fully at the Quick Eject buckle and flip the platform 180° so it extends under the pack back. Take a seat, adjust for comfort.

CargoChair Storage

Just snug up the straps and the CargoChair will ride flush against the pack body, or remove it and store in the zippered panel pocket.

6.

THE PIGGYBACK SYSTEM

Our Piggyback Systems allow you to attach a smaller (guest) Kifaru pack to a larger (host) Kifaru pack. Packs can be mounted high or low the host pack.

Low Mount System (you will need optional waistbelt and Low Mount Adapter)

The Low Mount allows you to load up the smaller pack's waistbelt with mag pouches, a Combat GunBearer, etc., and HAVE IT READY FOR immediate use in the event you jettison the smaller pack for action. It mounts low on the host pack with its waistbelt secure but unfurled ... at the ready.

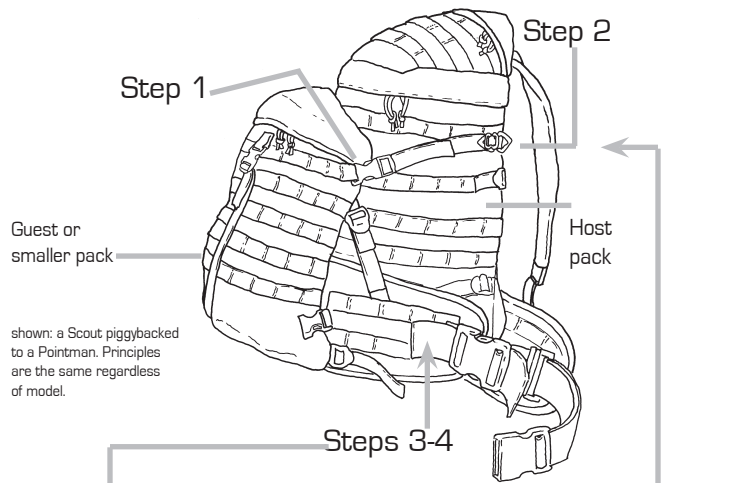

LOW MOUNT ADAPTER KIT

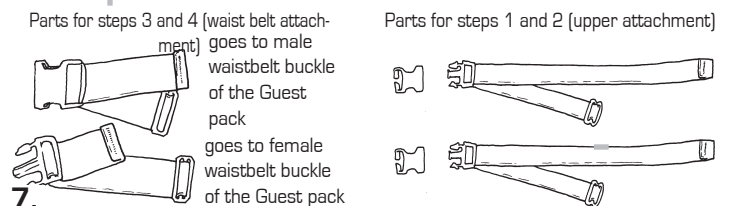

THE PIGGYBACK SYSTEM

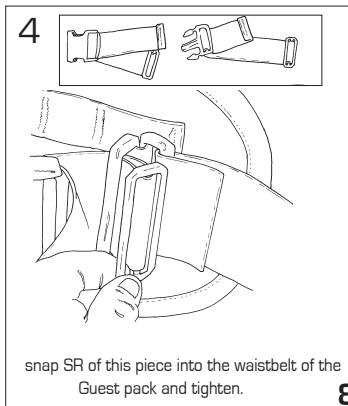
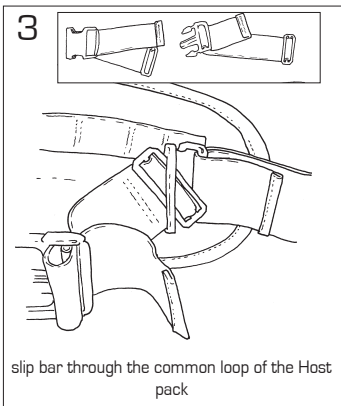
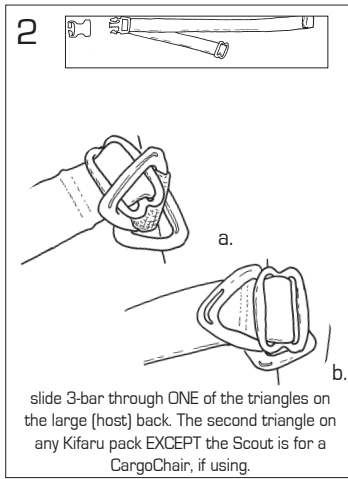

8

THE PIGGYBACK SYSTEM - JETTISON

Eject your guest pack in a flash. Just "click out" the top and bottom SR buckles. Grab your small pack and go.

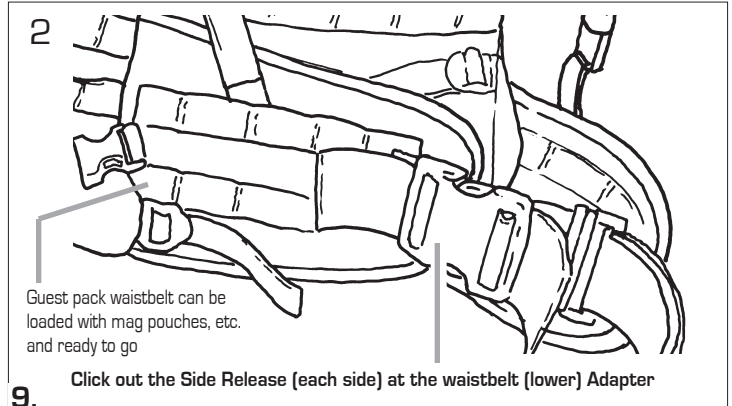
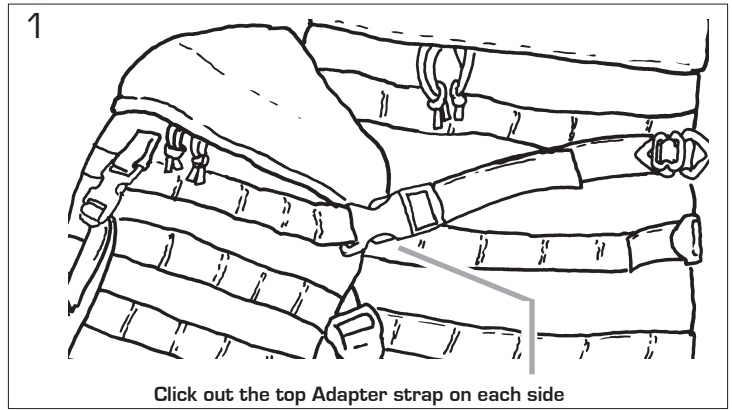

9.

THE PIGGYBACK SYSTEM - HIGH MOUNT

The High Mount System allows you to mount the smaller pack higher up on the host pack, and tuck its waistbelt away. A good carry position, but not as "ready to rock" as the low mount method.

You will need a Horizontal Lash Strap Kit to do a High Mount.

HORIZONTAL LASH STRAP COMPONENTS

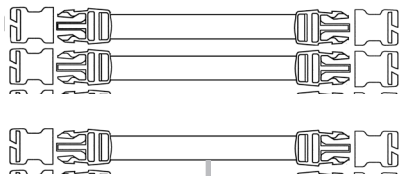

These two straps connect small pack at the top from:
a). top web loop to
b). large pack hood at rear



Run this strap around small pack body and affix to PALS on larger pack body



To jettison guest pack: Simply "click-out" at the SR buckles, top and sides.

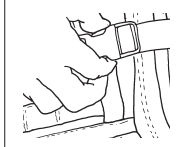

10.

ADD A COMBAT GUNBEARER™

The GunBearer lets you haul large, heavy firearms with the weight on your hips, not your shoulders, yet allows you to level it for firing in a split second. Leaves your hands free for other work.



The weight of your firearm rests comfortably on your hips

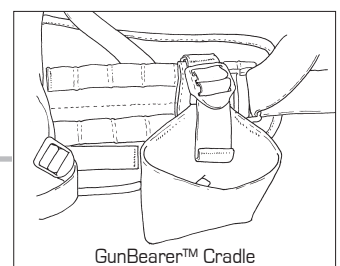
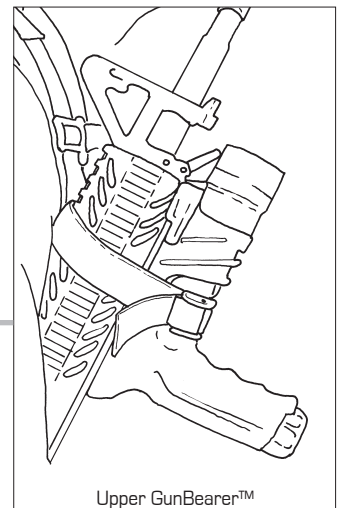

11.

INSTALLING THE UPPER GUNBEARER

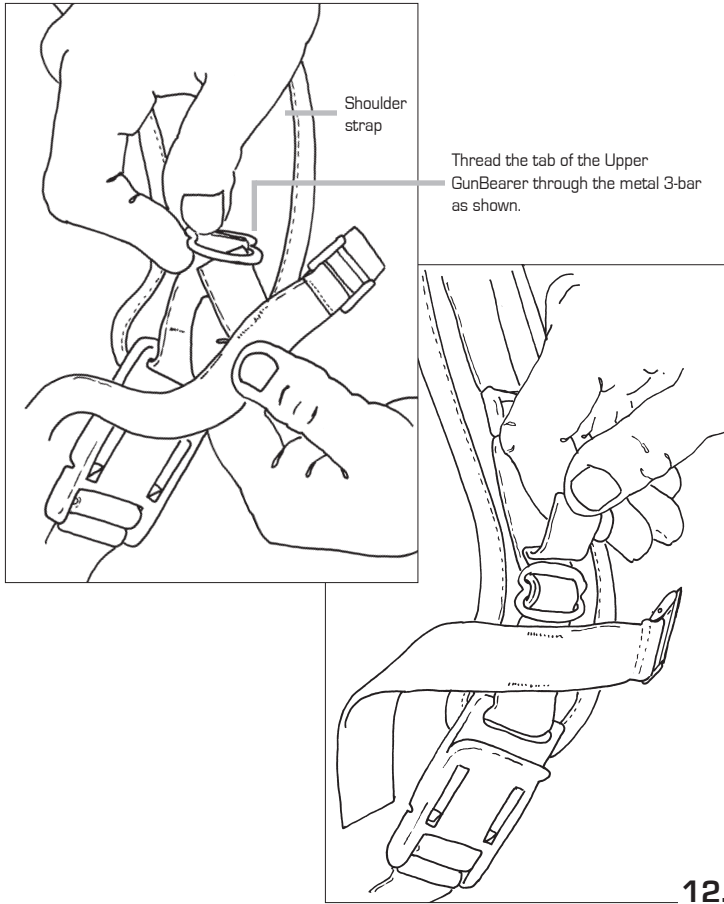

INSTALLING THE CRADLE

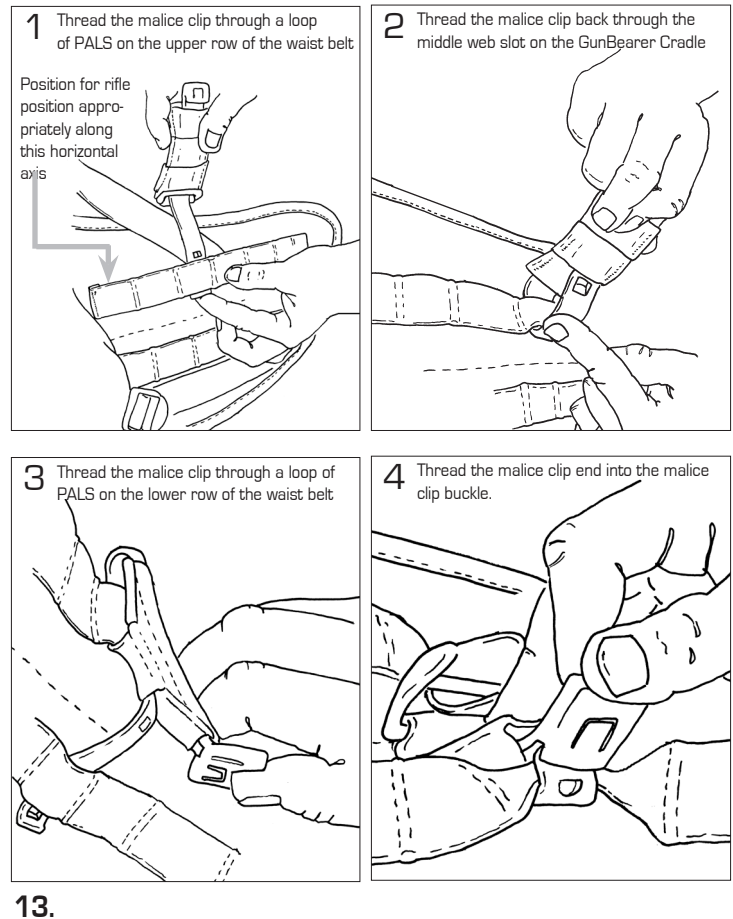

INSTALLING THE CRADLE

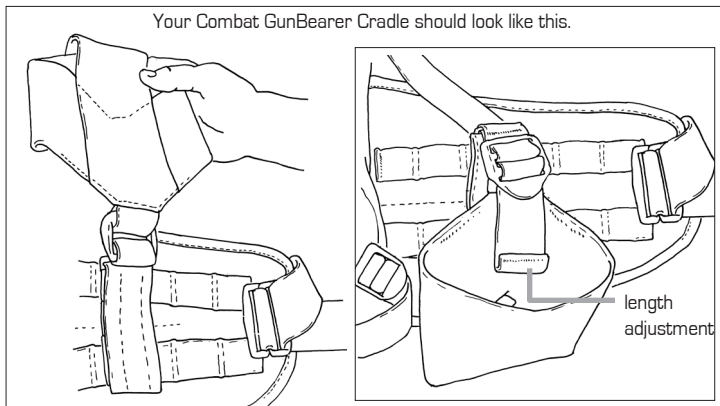

Place the firearm in the Cradle, and wrap the Upper GunBearer strap around the upper portion of the rifle, push down on the Camlock until you feel it click.

Your firearm is now securely in place, leaving your hands free.

Fine Tuning: If you find the barrel is too near your face, try some of the following:
move Cradle forward or backwards to change the angle of the weapon

Make sure the sternum strap is not too tight - this pulls the barrel into your facial area.

Cradle can also adjust vertically at length adjuster buckle.

Using the GunBearer: with the hand opposite the GunBearer, reach across and pull sharply outward on the end of the strap to pop the camlock open. Pull your firearm out of the Cradle and level.

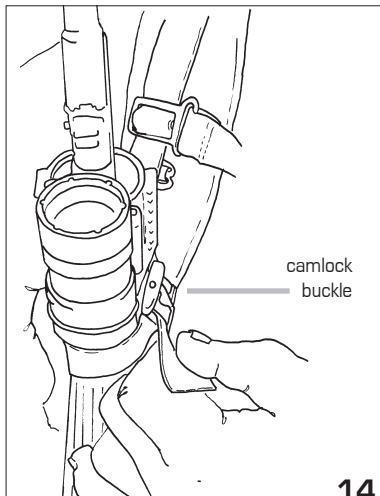

INSTALLING A WAISTBELT

Your Zulu is designed to be worn with or without a waistbelt, allowing you to wear the pack with other belt kits or packs.

